



Puddletown C Of E First School

Puddletown

Sensory Garden

January 2019

The copyright in this drawing is vested in Dorset Property, Dorset County Council and may not be reproduced without express permission.

Notes and Revisions 17

This map is based upon Ordnance Survey material with the permission of Ordnance Survey on behalf of the Controller of Her Majesty's Stationery Office.

© Crown Copyright 2009. Unauthorised reproduction infringes Crown copyright and may lead to prosecution or civil proceedings.

© Dorset County Council. LA 100019790. 2017.

Key

Proposed planted meadow area with plug planting
Cut and collect 275m2

Natural meadow area
Cut and collect less frequently than the planted meadow
300m2

Existing scrub planting

Existing scrub planting translocated to form new copse
35m2

10mm-dust Gravel pathway with timber edge
200m2

Proposed excavated dry river bed clay lined to allow it to fill with rain water
32m2

Proposed native hedgerow
450mm centres double staggered
80Lm

Existing native hedge

Timber log bridge
600x1000mm
x3

Sunken seating area with timber posts for parachute canopy

Timber sleeper stepping pieces.
600x200mm
x26

Proposed perennial colour block planting
5 per metre square.
50m2

Proposed post and rail fencing
65Lm
x2 pedestrian gates

Timber sleeper retaining wall
15Lm

Timber entrance to sensory garden with signage
30Lm

Willow tunnel
Willow whips planted each side of the pathway
5Lm

Proposed ornamental trees x3
Standard heavy
Height 350-425cm
Container grown

Proposed fruit trees x11
12litre pots

Proposed level fall

Dimensions

Existing timber decking

Existing pond

Landscape Services

County Hall, Colliton Park, Dorchester, Dorset DT1 1XJ
Telephone: 01305 225200
Landscape Service Manager: 01305 221699

www.dorsetforyou.gov.uk/dorset-property

Client

Puddletown C of E First School

Job Title

Sensory Garden

Drawing Title

Detail Plan

Scale	Date	Drawn By	Filename
1/250@A3	14.01.2019	AC	-
Property Ref.	Pims No.	Drawing No.	Revision
-	-	-	A

Dorset County Council

Working together for a strong and successful Dorset

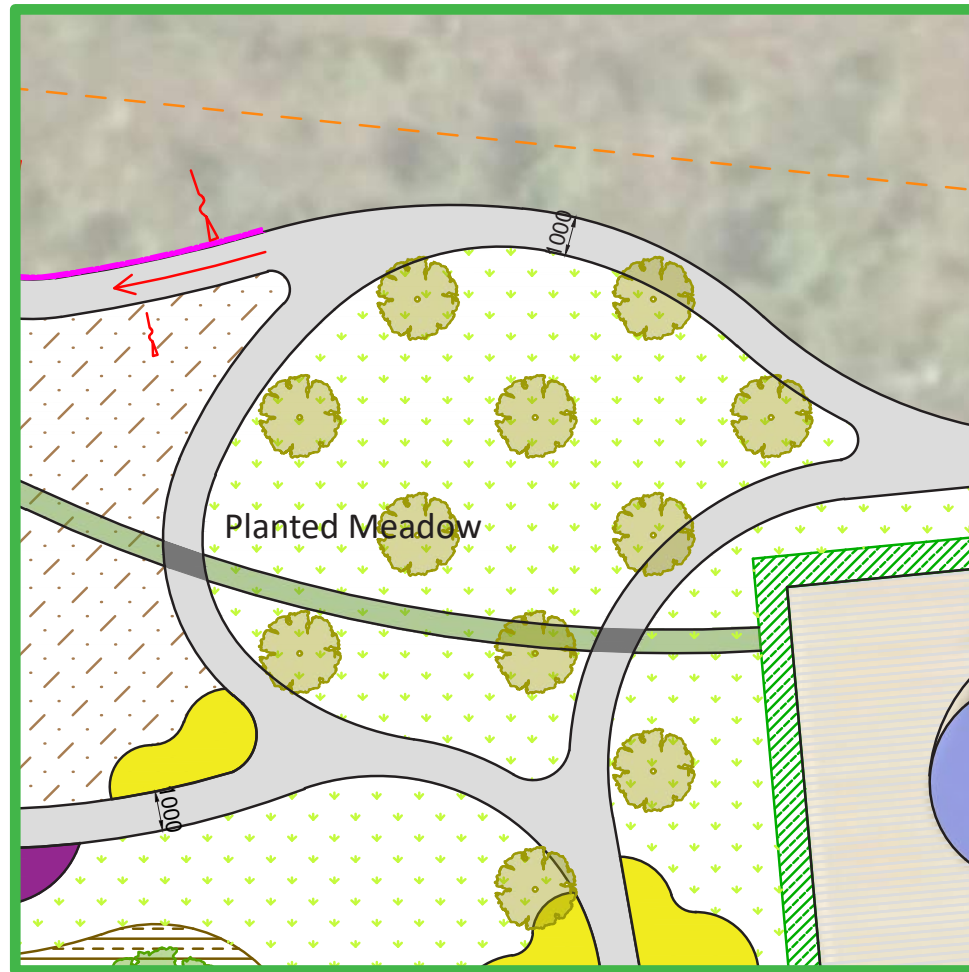

Meadow areas to be sown with a pollinator seed mix and planted with a mix of plug plants to increase visual and biodiversity interest. Cut and collect Frequency higher in this area to help remove the fertility, collect seeds and allow plug plants such as bulbs to grow.

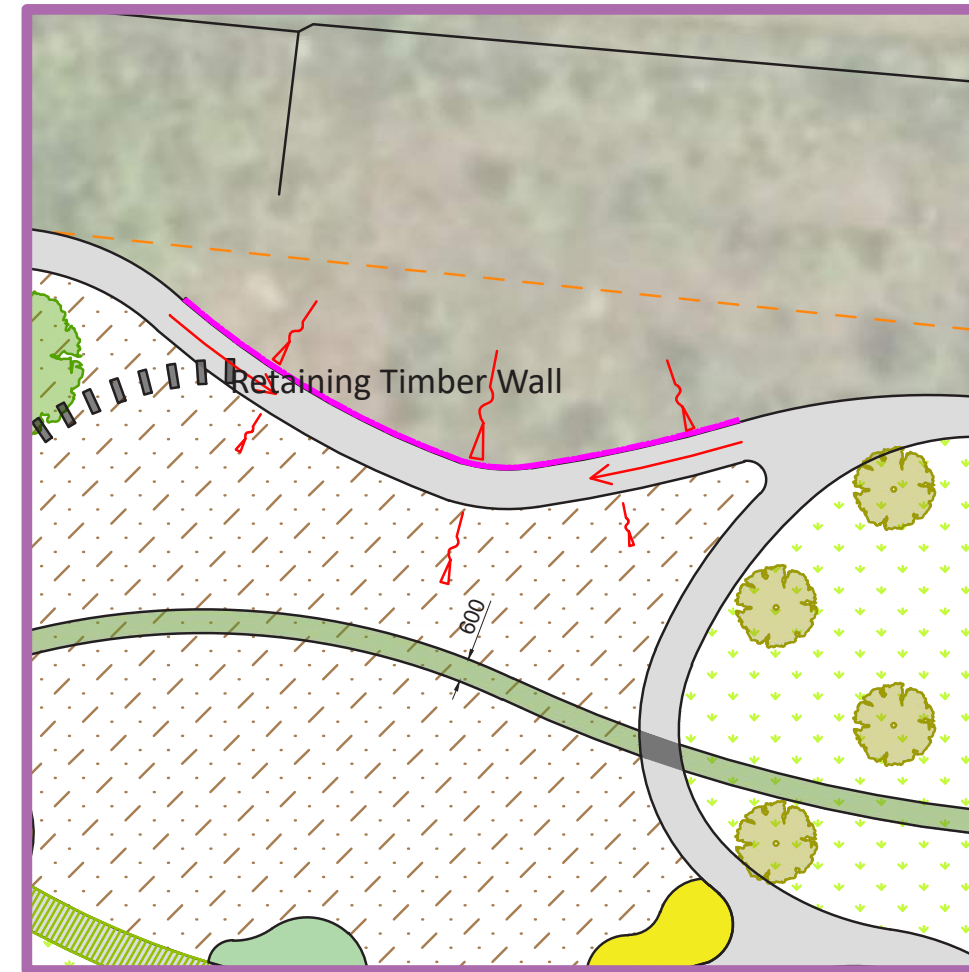

The proposed sensory garden will include playful colours, scented plants etc but the journey through the garden should also act as a subtle sensory change moving through different characters and transitions. Level changes could act as a subtle alteration to the journey by dropping the path with the use of retaining walls changing the sense of space and vistas from the garden.

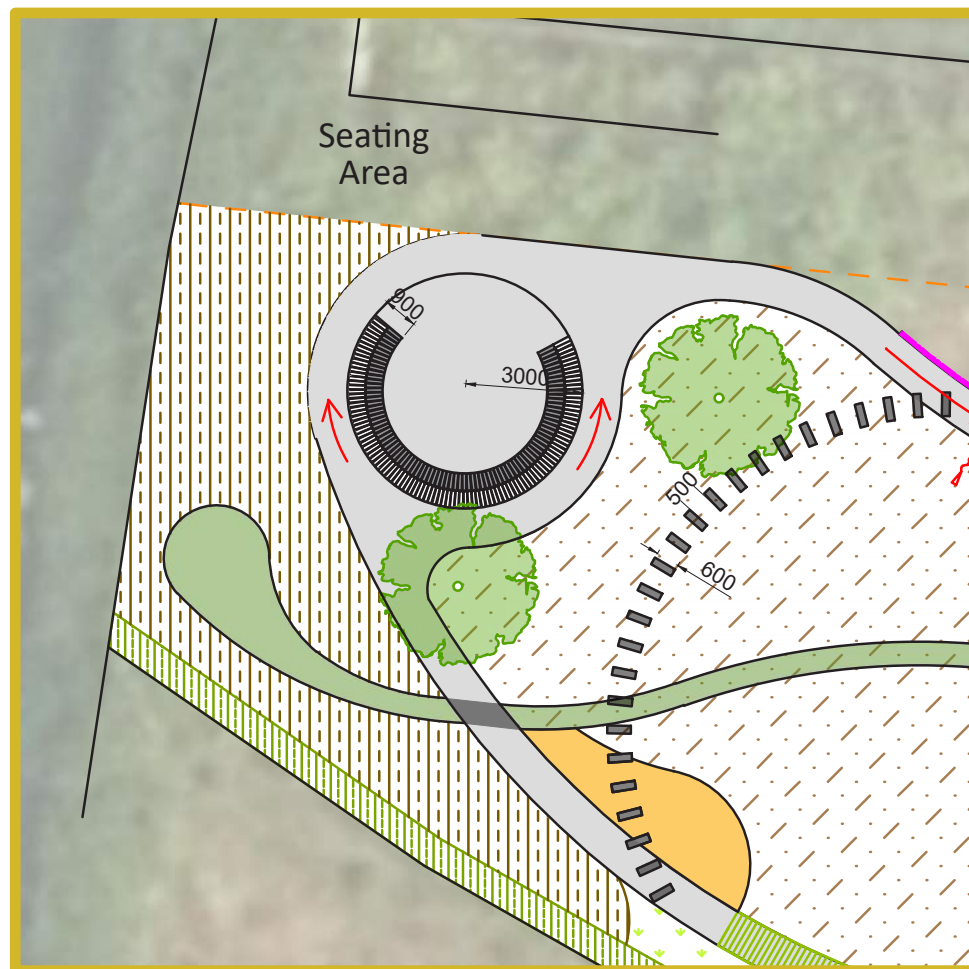

Working with the existing levels a partially sunken seating area can be created. This area will be large enough to hold a small class. Natural robinia timber posts installed around the circle so a temporary canopy such as a parachute can be fixed if required. The seating will be facing North with sun behind the children. The views will be looking out over the surrounding valleys.

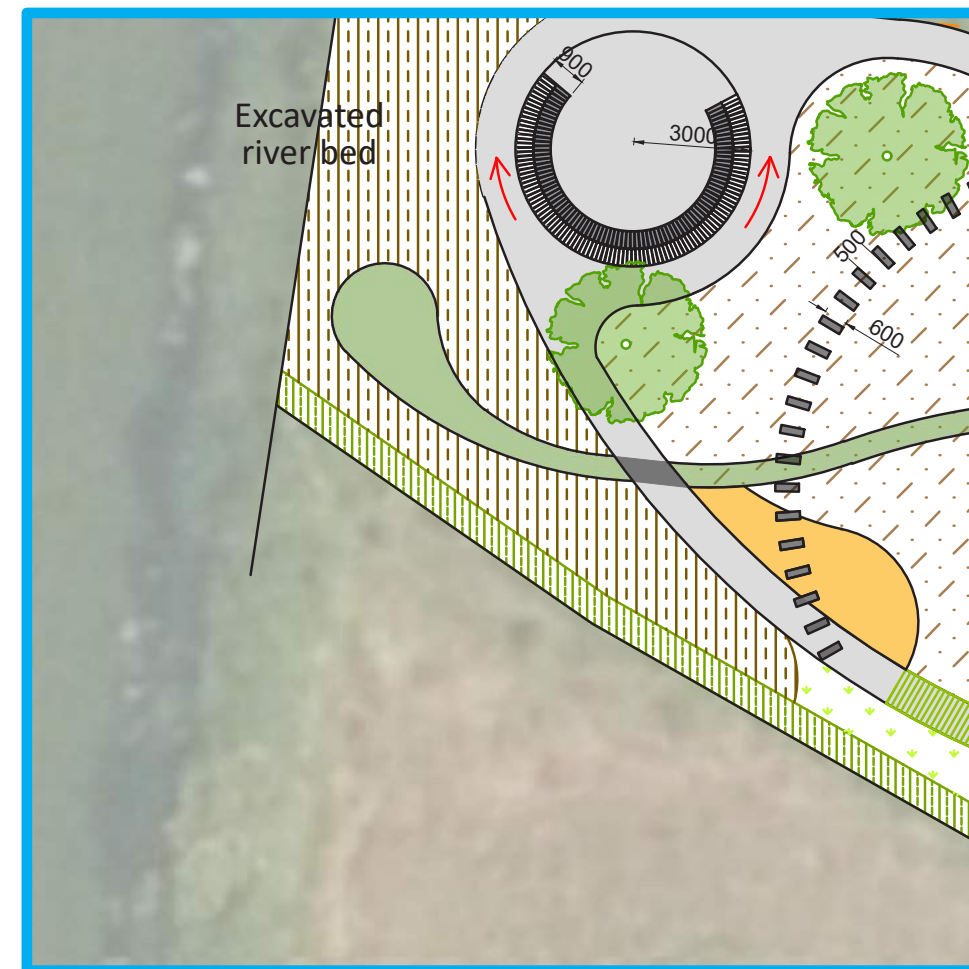

A proposed excavated channel to recreate a river bed leading crossing the garden leading to the pond. This channel could be lined and planted with wetland plants to allow the channel to naturally collect water. The feature could act as a learning geographical/science feature and as a play feature which could be used for physical activities such as jumping and rolling or creative learning such as mud kitchens.

